

*Featuring  
"Tomorrows Solutions Today"*

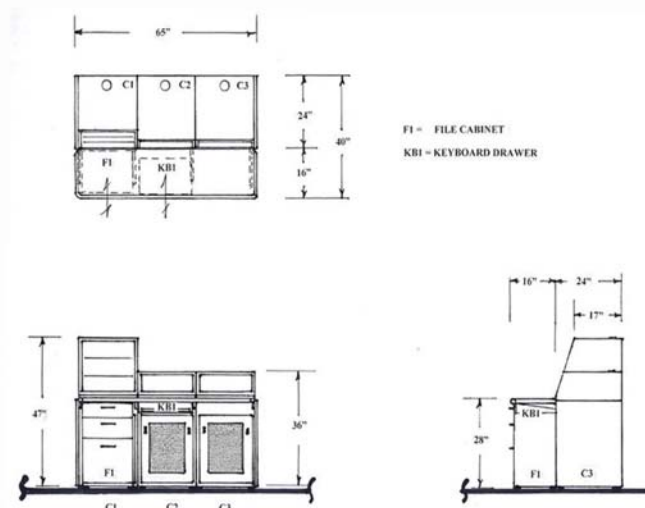

Shown With Optional Industrial Grade Filing

ACM3630



We offer a complete line of multi-dimensional metal bay and laminate style Control Center Furniture and accessories in a variety of configurations. Please contact us for a free consultation.



The **ACM3630** is configured as a single position control console .The layout foot print is approximately 62 “ x 40 . This configuration consists of 2 Legacy Line base cabinets with upper turrets (1 each 9RU and 2 each 3RU), constructed using a combination of 11 and 14 gauge cold rolled steel, unitized/welded construction.

All cabinets are constructed using a combination of 11 and 14 gauge cold rolled steel, unitized/welded construction and are manufactured in compliance with ISO9001 standards and AS9100 certified quality.

The 3RU Turrets are for operator accessible equipment mounting with easy to access rear doors, they make excellent platforms for placing LCD type displays as shown in the product illustration.

The base cabinets selected for this configuration are sized one at 21 “wide x 24” deep, and one at 42” wide x 24 “ deep. Both cabinets are equipped with 19” EIA mounting rails with optional fixed or slide out shelving available as may be needed. Easy to access, lift out vented doors are standard, optional hinged doors are available.

The assembly comes equipped with an in cabinet vertical ground buss compliant to Motorola R56 standards.

Cabinets are complimented with a laminate writing surface with rolled oak edges. All Laminate products are constructed in compliance with NEMA LD3 Standards, using marine grade ply board – available in a wide assortment of colors.

All cabinets are equipped with leg leveling devices, are pre-assembled and securely crated , ready for simple drop in place installation. Detailed drawings are sent with each console.

A wide variety of accessory items are available to compliment this configuration.

Please note that the accessory items shown ( LCD monitors – special panels etc) in the product illustration are not included with the product ,they have been shown to help with the preliminary conceptual planning.

The illustration displays the ACM3630 with an optional industrial grade under the surface file cabinet.

**Please contact us at:**

**American Wireless Inc.**

1780 East McFadden Ave., STE 112 • Santa Ana, CA 92705

Direct: 888-289-1555 • Fax: 714-542-0313

Email: [info@awicom.com](mailto:info@awicom.com)

Web site: <http://www.awicom.com>